

MODERN PENTATHLON



Modern Pentathlon will be staged in an ideal environment for athletes, officials, media and spectators in 2012 in the San Francisco Bay Area. Located in the midst of the Olympic Stadium Cluster at Stanford University, the selected venues are immediately adjacent to one another, less than 200 meters apart.

The Fencing and Shooting competitions will be staged in Maples Pavilion, a venue that provides intimate seating for 7,000 spectators and is renowned for its exciting atmosphere. Maples Pavilion is supported by extensive facilities in Arrillaga Family Sports Center.

Next to Maples Pavilion and Arrillaga Center, the newly renovated Avery Aquatics Complex will host the swimming competition. Avery Complex will also provide 7,000 seats at the home of one of the premier swimming programs in the world, a program that has produced many great Olympic champions.

A one-minute walk from Avery Complex, the famous Sunken Diamond will serve as the venue for the Riding and Running competitions, set up in a manner similar to that used in Sydney. With 10,000 seats available, Sunken Diamond will offer an outstanding atmosphere in a beautiful setting, right next to the Olympic Stadium, the Hospitality Village and the Expo Mall.

These facilities would be available for four days of competition if the UIPM were to decide to feature relay competitions in 2012.

With excellent competition conditions at venues as compact as possible, all located at the heart of the Olympic Games, the Modern Pentathlon will have the showcase that its dedicated, multitalented athletes deserve.



Photo by John Todd

- 10.1** *In strict accordance with the answers given for question 9.1.1, give a detailed list of the total number of proposed competition venues, indicating the disciplines and events to be held at each site.*

Modern Pentathlon: Stanford University (Maples Pavilion, Avery Aquatics Center, Sunken Diamond), Palo Alto

A complete listing of all events for all disciplines is presented in **Table 10.7.3a – Daily Schedule**.



Maples Pavilion



Sunken Diamond

10.2 *Give the total number of proposed training venues.*

For Modern Pentathlon, BASOC has established Chabot College in Hayward as the training venue. For riding, Portola Valley Riding Center and CTETA in Woodside are both available and within five miles of the competition venue.

10.3 *Indicate on a map (giving the scale used) the location of the competition venues mentioned in question 10.1, as well as that of the Olympic Village, the MPC, the IBC, the Judges and Referees Village and the Media Village (if applicable). Indicate on the map the distance in miles, kilometers and travel time (in current and future conditions, and if improvements are planned between these different sites).*

The location of the Modern Pentathlon venue at Stanford University is indicated on **Map 10.3 – Modern Pentathlon**. This map also shows the relationship of the venue to the Olympic Village, the MPC, the IBC, the Judges and Referees Village, the Media Hotel Cluster and the Media Village.

Table 10.3 Distance and Travel Times

SPORT	VENUE	OLYMPIC STADIUM & JUDGES/REFEREES VIL.		OLYMPIC VILLAGE & IBC		MAIN PRESS CENTER		IOC/USOC HOTELS	
		mi/km	mins ¹	mi/km	mins ¹	mi/km	mins ¹	mi/km	mins ¹
Modern Pentathlon	Stanford University	1/1.6	5/3	7/11	15/10	15/24	25/20	34/55	48/41

¹Please note: travel times are expressed in 2000 minutes/2012 minutes



- 10.4** For each competition venue, prepare a table showing:
- 10.4.1** Current state of each venue, specifying which of the following descriptions apply:
- Requires minor adaptations for the Olympic Games
 - Exists but substantial alterations (upgrading/refitting required)
 - Not yet built
- 10.4.2** Work schedule:
- For those venues already existing, give dates of commencement and completion of any work necessary. Also indicate the original date of construction for each venue.
 - For those venues to be built, give dates of commencement and completion of construction.
- 10.4.3** Cost:
- Estimated cost of work required;
 - Financing arrangements (amount in figures and percent total).
- 10.4.4** Name of current owner (and of future owner if venue is to change hands) and current status of agreements with owners concerning use if site for the Olympic Games, indicating whether these are already signed or to be negotiated (in accordance with the guarantees given in Section 9.1.5).

Table 10.4 Modern Pentathlon (Fencing & Shooting) – Maples Pavilion, Stanford University, Palo Alto

Status	Existing
Original Date of Construction	1969
Work Schedule	6/2012–7/2012
Costs	\$50,000
Financing	OCOG
Current Owner	Stanford University
Agreement	Yes

Modern Pentathlon (Riding & Running) – Sunken Diamond, Stanford University, Palo Alto

Status	Existing
Original Date of Construction	Built 1931 Renovated 2001
Work Schedule	7/2012
Costs	\$100,000
Financing	OCOG
Current Owner	Stanford University
Agreement	Yes

Modern Pentathlon (Swimming) – Avery Aquatics Center, Stanford University, Palo Alto

Status	Minor Adaptation
Original Date of Construction	Finished 2001
Work Schedule	7/2012
Costs	\$100,000
Financing	OCOG
Current Owner	Stanford University
Agreement	Yes

- 10.5** *Give the status of negotiations with the NGB concerned on use of the site, indicating whether these are already signed or to be negotiated. The original documents provided by the NGBs and must be given to the USOC (Theme 19 – Guarantees).*

US Modern Pentathlon Association has approved the proposed preliminary plans for Stanford University as the venue for Modern Pentathlon for the 2012 Olympic Games in the San Francisco Bay Area. The original document is provided in **Theme 19 – Guarantees**.

- 10.6** *For each venue, give details of its proposed use after the Olympic Games.*

After the Olympic Games, the facilities at Stanford University will continue to be used for collegiate athletic training and competition.

- 10.7** *For each venue (according to its use for the Olympic Games) give the following information:*

- 10.7.1** *A detailed plan giving the scale used, showing all the basic elements:*

- *Warm-up and competition areas*
- *Technical installations required*
- *Areas reserved for athletes, VIPs and guests, media, organizers, etc.*
- *Access*
- *Services (cloakrooms, press rooms, etc.)*

A detailed plan that shows all basic elements for the Modern Pentathlon venue at Stanford University is presented in **Diagram 10.7 – Modern Pentathlon**.

10.7 MODERN PENTATHLON

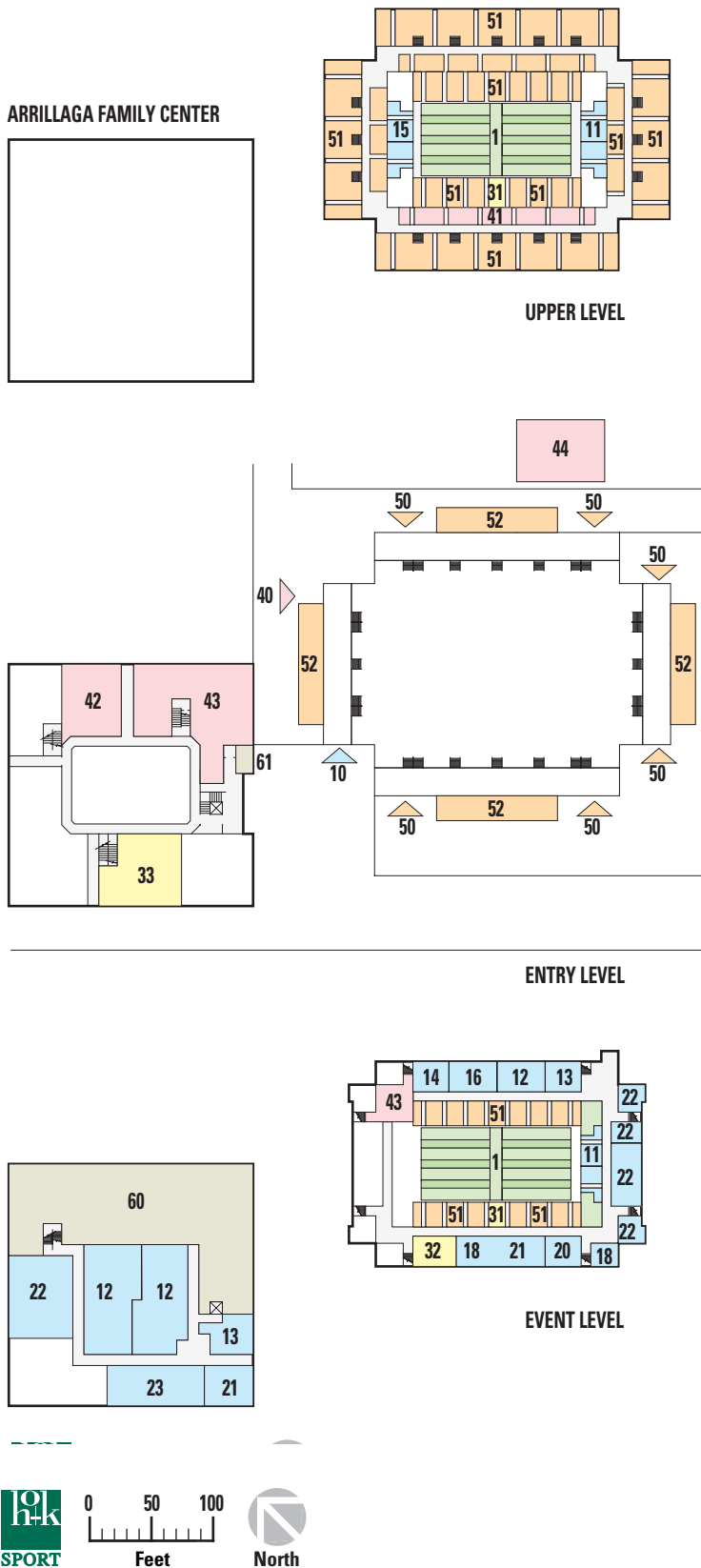

**Maples Pavilion
Stanford University
Palo Alto
Fencing**

Field of Play

- 1 Competition Area – Field of Play

Competition

- 10 Athletes Entrance
- 11 Athletes Seating
- 12 Athletes Change Rooms
- 13 Athletes Lounge
- 14 Officials Changing Room
- 15 Officials Seating
- 16 Officials Facilities
- 18 Tournament Operations
- 20 Athletes Medical
- 21 Doping Control
- 22 Competition Management
- 23 Physiotherapy/Massage
- 24 Weigh In
- 25 Sauna

Olympic Family Services

- 30 Olympic Family Entrance
- 31 Olympic Family Seating
- 32 UIPM Executive Offices (includes President & Secretariat)
- 33 Olympic Family Lounge

Media

- 40 Media Entrance
- 41 Media Seating
- 42 Media Subcenter
- 43 Mixed Zone (Interview)
- 44 Broadcast/Compound

Spectator

- 50 Spectator Entrance
- 51 Spectator Seating
- 52 Spectator Facilities

Venue Operations

- 60 Venue Management (OCOg)
- 61 Security & Accreditation
- 62 Other Compound

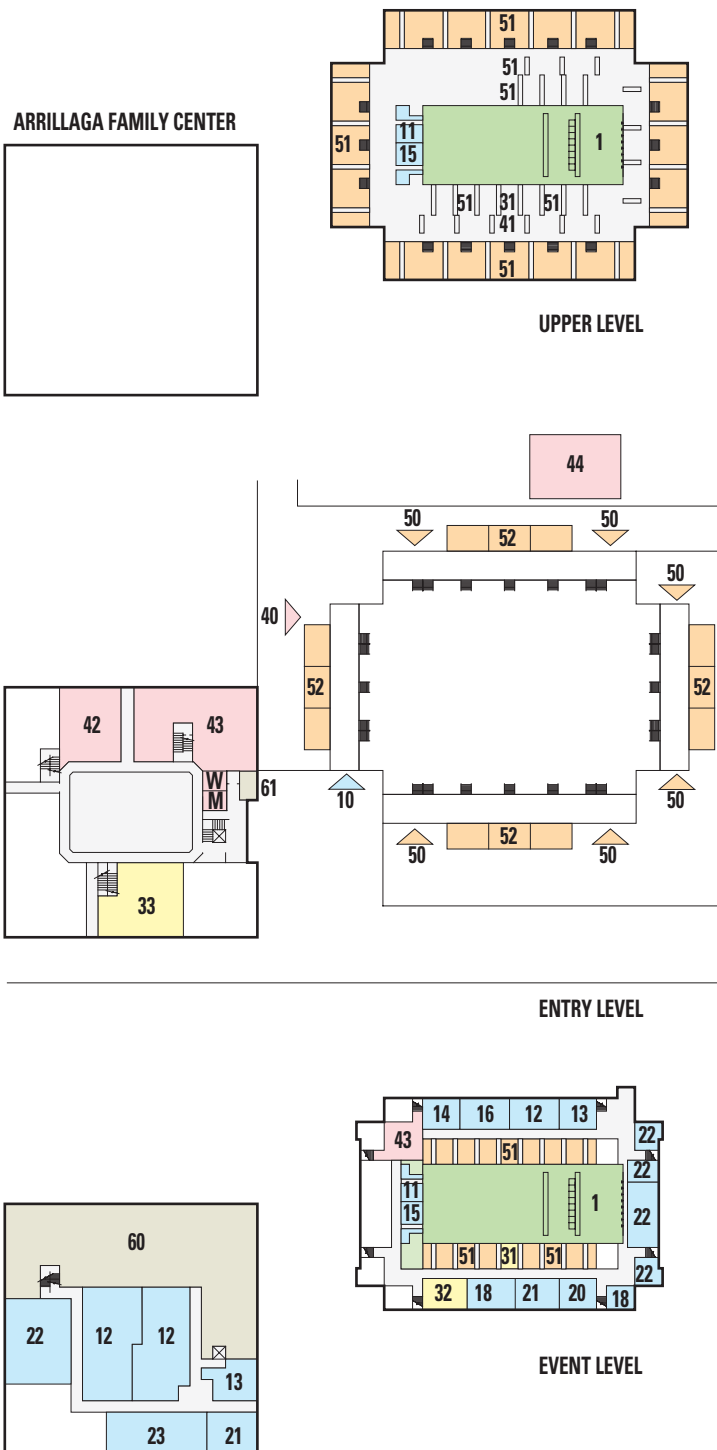

**Maples Pavilion,
Stanford University,
Palo Alto
Shooting**

Field of Play

- 1 Competition Area – Field of Play

Competition

- 10 Athletes Entrance
- 11 Athletes Seating
- 12 Athletes Change Rooms
- 13 Athletes Lounge
- 14 Officials Changing Room
- 15 Officials Seating
- 16 Officials Facilities
- 18 Tournament Operations
- 20 Athletes Medical
- 21 Doping Control
- 22 Competition Management

Olympic Family Services

- 30 Olympic Family Entrance
- 31 Olympic Family Seating
- 32 UIPM Executive Offices (includes President & Secretariat)
- 33 Olympic Family Lounge

Media

- 40 Media Entrance
- 41 Media Seating
- 42 Media Subcenter
- 43 Mixed Zone (Interview)
- 44 Broadcast/Compound

Spectator

- 50 Spectator Entrance
- 51 Spectator Seating
- 52 Spectator Facilities

Venue Operations

- 60 Venue Management (OCOG)
- 61 Security & Accreditation
- 62 Other Compound



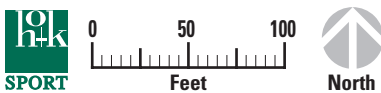
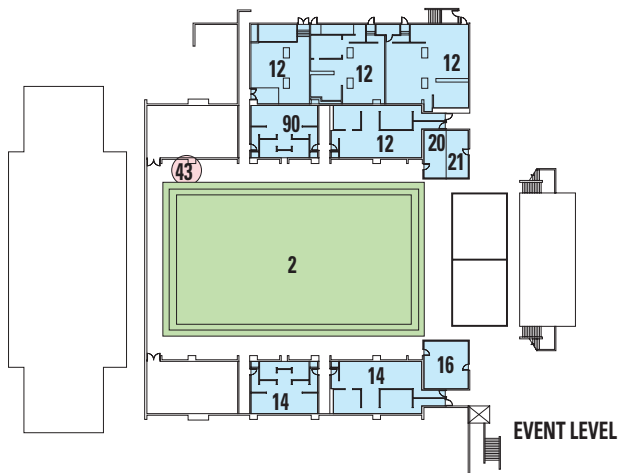
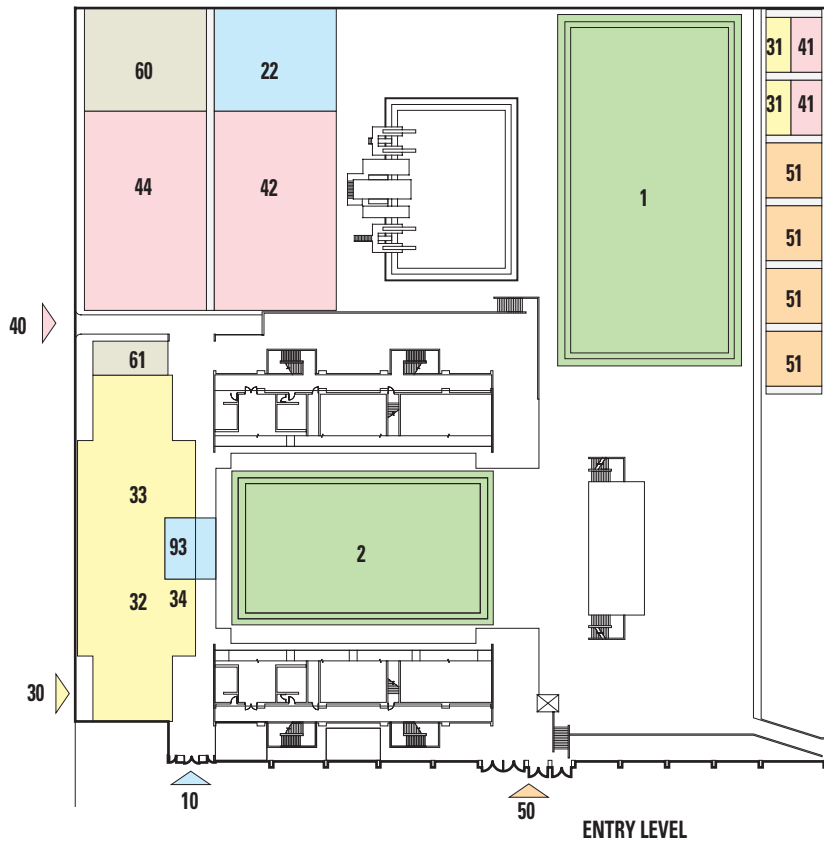

Avery Aquatics Center, Stanford University, Palo Alto

Field of Play

- 1 Competition Area – Field of Play
- 2 Practice/Warm Up

Competition

- 10 Athletes Entrance
- 11 Athletes Seating
- 12 Athletes Change Rooms
- 13 Athletes Lounge
- 14 Officials Changing Room
- 15 Officials Seating
- 16 Officials Facilities
- 20 Athletes Medical
- 21 Doping Control
- 90 Call Room
- 93 Timing, Scoring Control, Event Production

Olympic Family Services

- 30 Olympic Family Entrance
- 31 Olympic Family Seating
- 32 UIPM Executive Offices (includes President & Secretariat)
- 33 Olympic Family Lounge
- 18 Technical Water Polo Committee

Media

- 40 Media Entrance
- 41 Media Seating
- 42 Media Subcenter
- 43 Mixed Zone (Interview)
- 44 Broadcast/Compound

Spectator

- 50 Spectator Entrance
- 51 Spectator Seating
- 52 Spectator Facilities

Venue Operations

- 60 Venue Management (OCOG)
- 61 Security & Accreditation

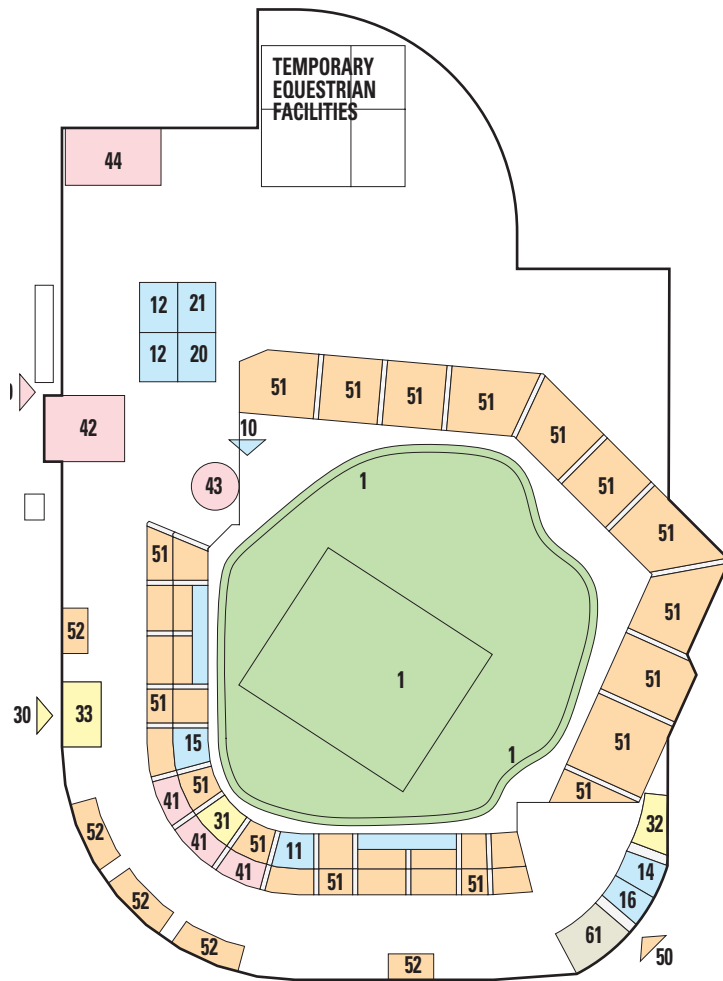

**Sunken Diamond,
Stanford University,
Palo Alto**

Field of Play

- 1 Competition Area – Field of Play
- 2 Practice Field

Competition

- 10 Athletes Entrance
- 11 Athletes Seating
- 12 Athletes Change Rooms
- 13 Athletes Lounge
- 14 Officials Changing Room
- 15 Officials Seating
- 16 Officials Facilities
- 20 Athletes Medical
- 21 Doping Control
- 22 Competition Management

Olympic Family Services

- 30 Olympic Family Entrance
- 31 Olympic Family Seating
- 32 UIPM Executive Offices (includes President & Secretariat)
- 33 Olympic Family Lounge

Media

- 40 Media Entrance
- 41 Media Seating
- 42 Media Subcenter
- 43 Mixed Zone (Interview)
- 44 Broadcast/Compound

Spectator

- 50 Spectator Entrance
- 51 Spectator Seating
- 52 Spectator Facilities

Venue Operations

- 60 Venue Management (OCOG)
- 61 Security & Accreditation
- 62 Other Compound

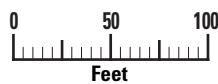

10.7.2 Capacity for Olympic Games

- Total number of seats
- From among the total number, indicate the number of seats reserved for the general public
- For open-air venues, give (in addition to the number of seats) the potential total capacity according to the area available and the absorption capacity of entrances/exits

The total number of available seats for Modern Pentathlon at Stanford University is 7,000, of which 5,950 are reserved for the general public.

10.7.3 Competition Schedule

Give the days of use of the venue(s) according to the competition schedule of the sport in question. If the venue is used for other sports, specify which ones, the days of use per sport, and how the schedule has accommodated this use.

A daily schedule for the Modern Pentathlon competition during the 2012 Olympic Games is provided in **Table 10.7.3a – Modern Pentathlon**. A detailed session schedule is presented in **Table 10.7.3b – Modern Pentathlon**.

Table 10.7.3a Daily Schedule – Modern Pentathlon

JULY/AUGUST 2012	11 SAT DAY 15			12 SUN DAY 16			GOLD MEDALS	
SPORT/EVENT	M	A	E	M	A	E		
Women's				■	G			
Men's	■	G						
Gold Medal Totals	1			1			2	

Table 10.7.3b Session Schedule – Modern Pentathlon

DAY	DATE	SESSION	EVENT	TIME BEGIN	TIME END
15	8/11	1	Men's Shooting, 10m Air Pistol Men's Fencing, Epee Men's Swimming, 200m Freestyle Men's Showjumping, 12 Jumps Men's Running, 3km Cross Country	645	1740
16	8/12	3	Women's Shooting, 10m Air Pistol Women's Fencing, Epee Women's Swimming, 200m Freestyle Women's Showjumping, 12 Jumps Women's Running, 3km Cross Country	645	1740